

County Surveyor's Record Tillamook County, Oregon

RESTORED CORNER FOR STATE OF OREGON--DEPARTMENT OF FORESTRY

Section corner common to Sections 19,
20, 29 and 30, T1S, R7W, W.M., Tillamook
County, Oregon.

ORIGINAL

Post, (missing) from which a:

- 30" Fir bears S62°W 34 lks.; now 40" badly decayed uprooted stump, out of place, scribes T1S R7W S30 BT visible.
- 40" Fir bears N40½°W 35 lks.; now 60" stump, scribes partially visible.
- 36" Fir bears N62°E 70 lks.; now 30" rotted stub, scribes rotted away.
- 40" Fir bears S67°E 12 lks.; now 15" rotted stub bears S47°E, scribes rotted away.

RESTORED

Set 1½" x 36" galvanized iron pipe with 3" bronze cap marked "OREGON STATE BOARD OF FORESTRY T1S R7W S19 S20 S30 S29 1981 RS401", 34 inches in ground, in mound of rock, and from which a:

- 6" Fir bears S59°W 7.2 ft. to face; scribed T1S R7W S30 BT RS401.
- 6" Fir bears S46°E 14.9 ft. to face; scribed T1S R7W S29 BT.
- 4" Fir bears N88°E 9.4 ft. to face; scribed x BT.

Set 4" x 4" x 60" white painted Cedar post NW 1.3 ft. from corner pipe. Oregon State Forestry Department metal location poster on original 40" BT, N40½°W.

DATED: March 9, 1981

RESTORED BY: Anthony J. Klosterman under my direction.
Anthony J. Klosterman, District Engineer

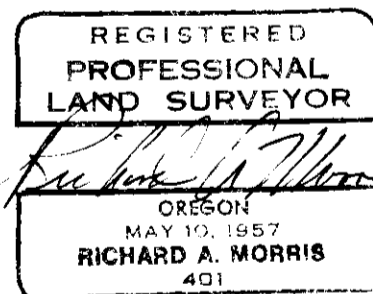

PRESENT AND WITNESSED BY: David B. Buchholz
Danny J. Benson